

*DENOTES CONTINUOUS SUPPORT STRUCTURE NOT BY KALWALL INSTALLERS
 (* DENOTES ADJUSTMENT SHIMS TO BE SUPPLIED BY KALWALL INSTALLER
 TO ACCOMMODATE SECONDARY STEEL TOLERANCES, ENGINEER TO ADVISE TOLERANCES.

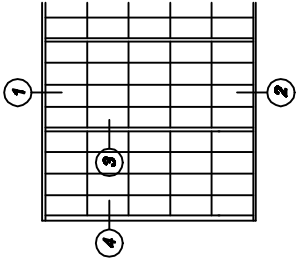

**KEY ELEVATION
 [PORTRAIT APPLICATION]**

3

2" (50mm)
 wall batten.

4

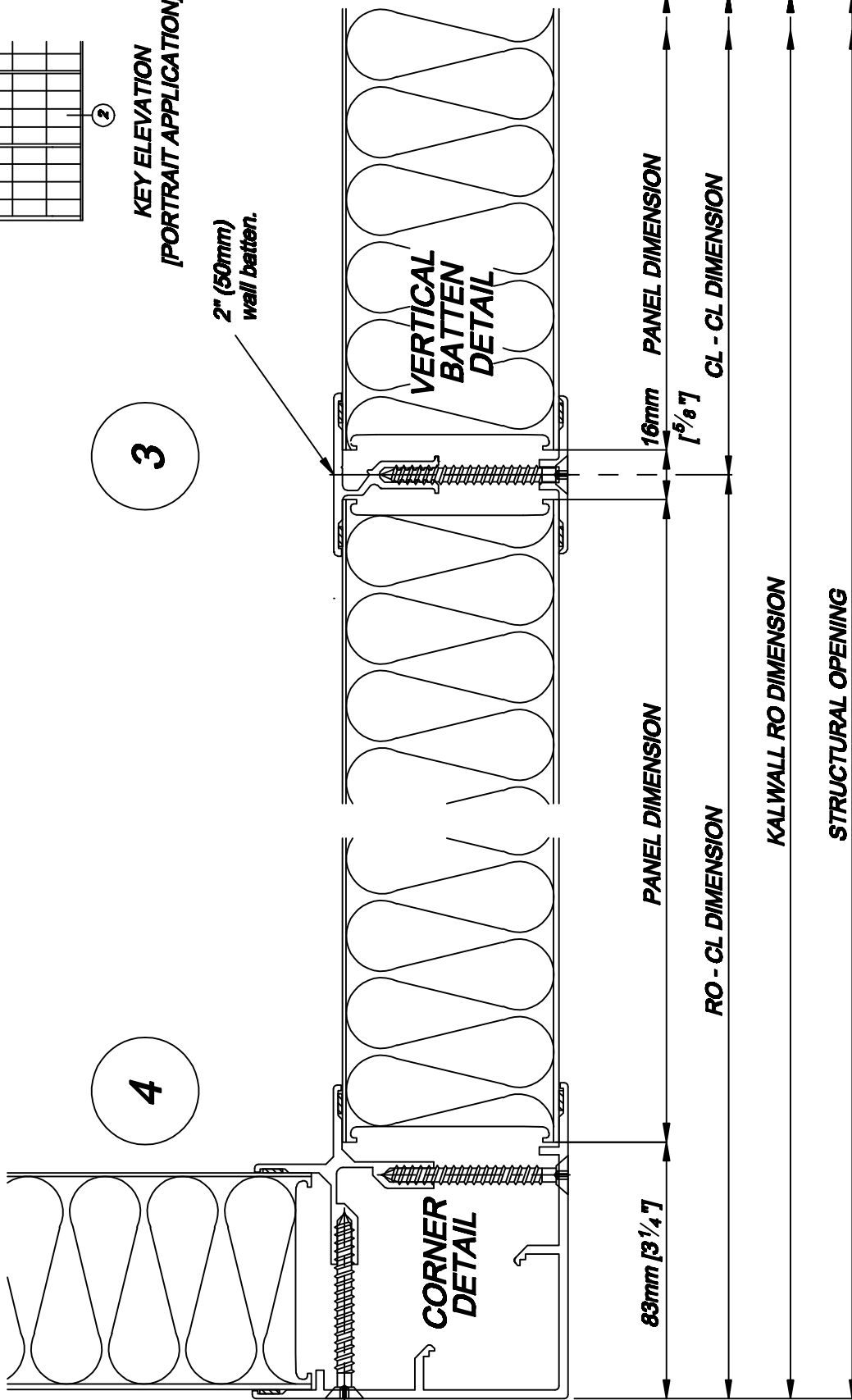

**KALWALL STANDARD CORNER & VERTICAL BATTEN [2"]
 THERMALLY BROKEN WALL PANEL DETAILS**

Stokes Systems Ltd. 1, Banstead road, Purley, Surrey. CR6 3EB
 Tel: 020 8990 7067 Fax: 020 8990 5707 Email: design@stokes.co.uk

This drawing is copyright and may not be reproduced in whole or in part without written consent of Stokes Systems Limited.

STOKES
 STOKES SYSTEMS LTD

Detail Ref.	
08T-STD/07	
Date. Jan. 2004	Rev. D
System. 08T	Scale. 1=2