

**STANDARD APPLICATION**

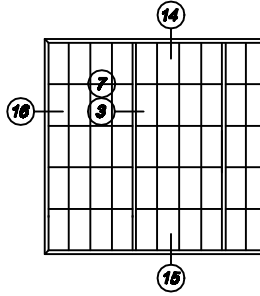

**KEY ELEVATION  
[PORTRAIT APPLICATION]**

**[513C] 5.5 x 85 self drilling  
fixings or similar by KALWALL  
INSTALLER.**

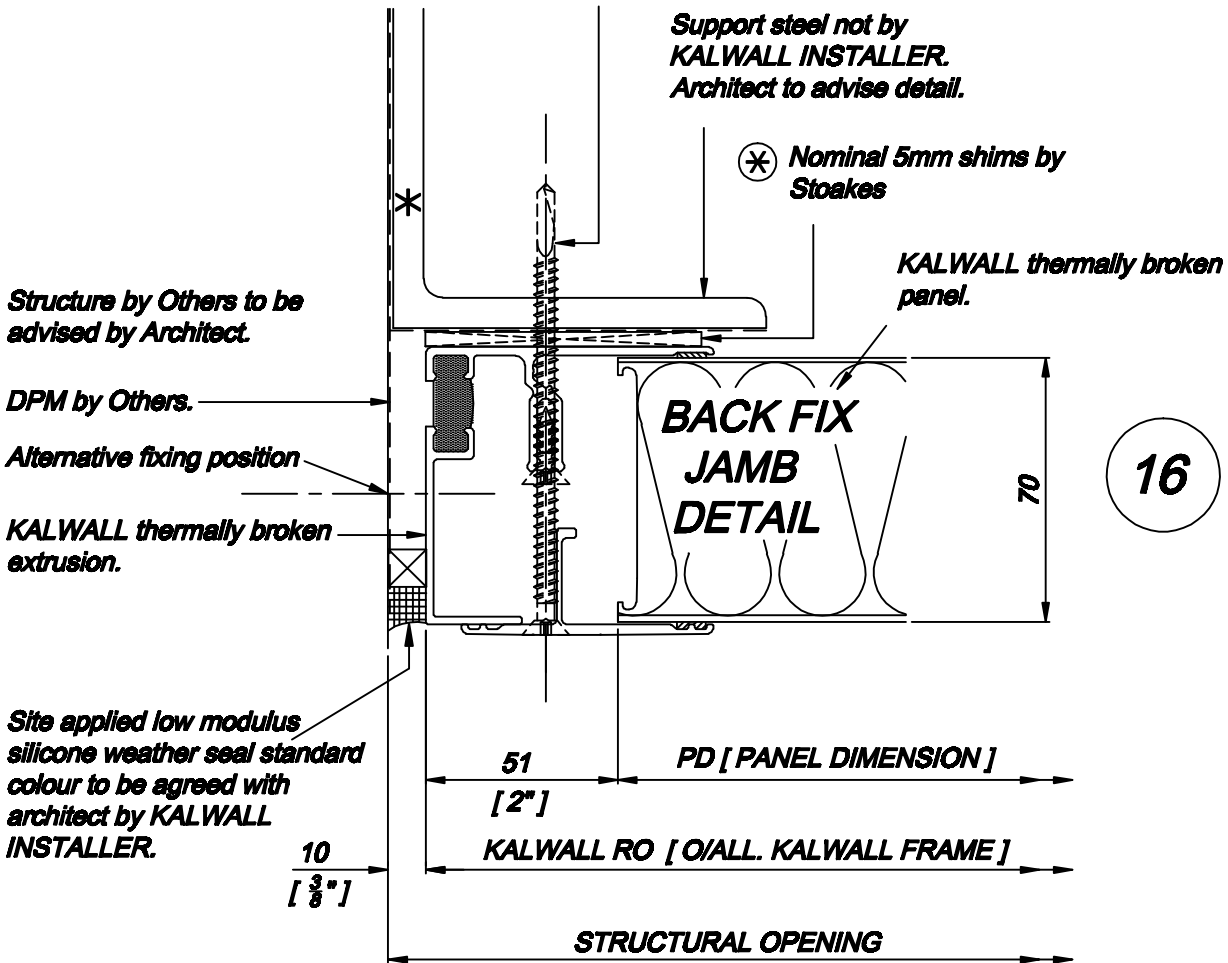

\* DENOTES CONTINUOUS SUPPORT STRUCTURE NOT BY KALWALL INSTALLER

⊗ DENOTES ADJUSTMENT SHIMS TO BE SUPPLIED BY STOAKES SYSTEMS TO ACCOMMODATE SECONDARY STEEL TOLERANCES, ENGINEER TO ADVISE TOLERANCES.

**KALWALL STANDARD BACKFIX JAMB CLAMPTITE  
THERMALLY BROKEN WALL PANEL DETAILS**

Stoakes Systems Ltd. 1, Banstead road, Purley, Surrey. CR8 3EB  
Tel: 020 8000 7867 Fax: 020 8000 5707 Email: design@stoakes.co.uk

This drawing is copyright and may not be reproduced in whole or in part without written consent of Stoakes Systems Limited.

**STOAKES**  
STOAKES SYSTEMS LTD

Detail Ref.

**08T-STD/13**

Date.	May 2005	Rev.	D
System.	08	Scale.	1-2