

**REFER TO 08T-STD/15 FOR KEY ELEVATION  
FLUSH PANEL APPLICATION**

**08T-STD/14**

*Panels and flashing not by  
KALWALL INSTALLER.*

*25 thick PIR board insulation  
not by KALWALL INSTALLER.*

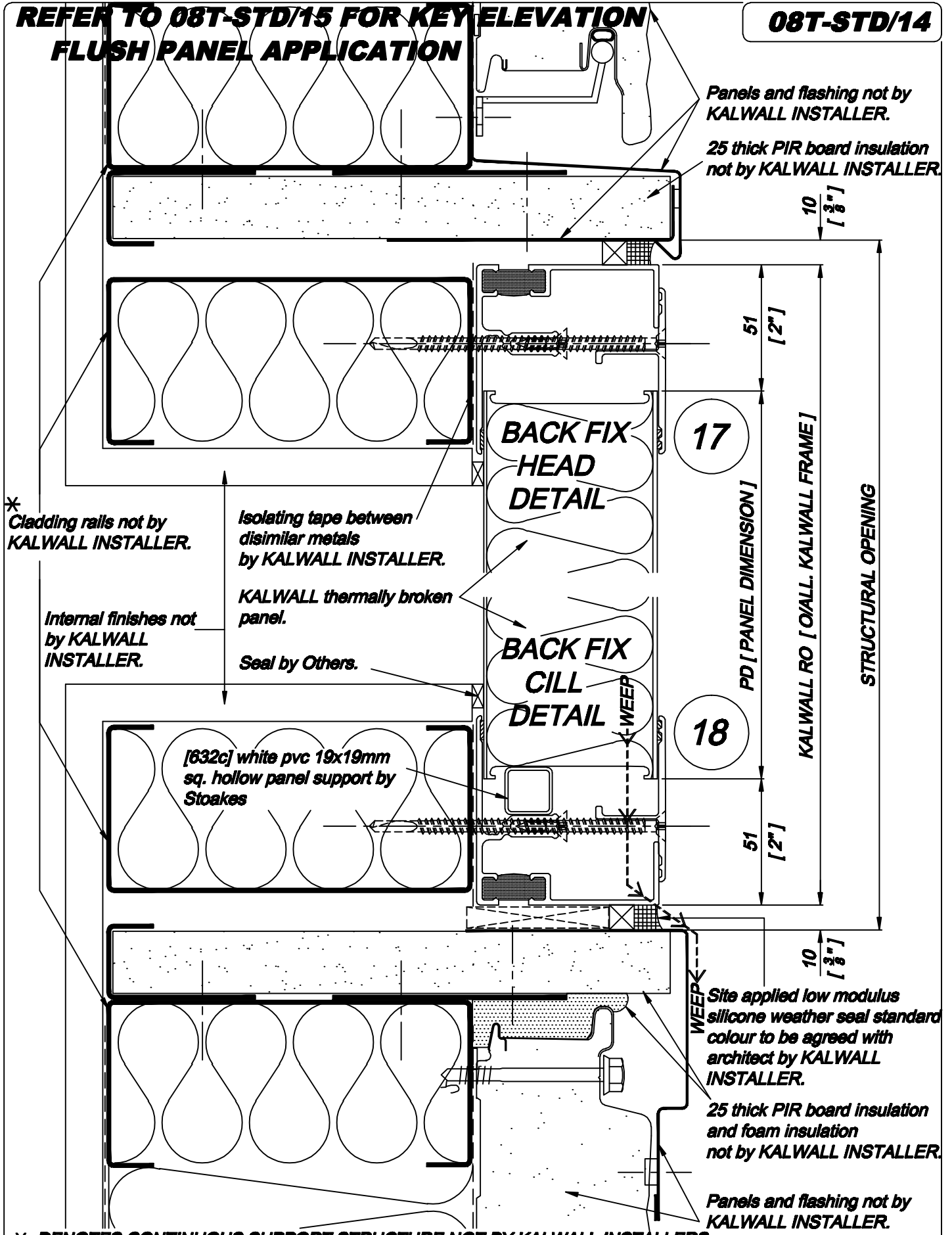

\* *Cladding rails not by  
KALWALL INSTALLER.*

*Isolating tape between  
disimilar metals  
by KALWALL INSTALLER.*

*Internal finishes not  
by KALWALL  
INSTALLER.*

*KALWALL thermally broken  
panel.*

*Seal by Others.*

*[632c] white pvc 19x19mm  
sq. hollow panel support by  
Stokes*

17

**BACK FIX  
HEAD  
DETAIL**

51  
[2"]

PD [ PANEL DIMENSION ]

KALWALL RO [ OVAL. KALWALL FRAME ]

STRUCTURAL OPENING

18

**BACK FIX  
CILL  
DETAIL**

51  
[2"]

10  
[3/8"]

*Site applied low modulus  
silicone weather seal standard  
colour to be agreed with  
architect by KALWALL  
INSTALLER.*

*25 thick PIR board insulation  
and foam insulation  
not by KALWALL INSTALLER.*

*Panels and flashing not by  
KALWALL INSTALLER.*

\* DENOTES CONTINUOUS SUPPORT STRUCTURE NOT BY KALWALL INSTALLERS

**KALWALL STANDARD BACKFIX HEAD & CILL CLAMPTITE  
THERMALLY BROKEN WALL PANEL DETAILS**

Stokes Systems Ltd. 1, Banstead road, Purley, Surrey. CR8 3EB  
Tel: 020 8000 7067 Fax: 020 8000 5707 Email: design@stokes.co.uk

This drawing is copyright and may not be reproduced in whole or in part without written consent of Stokes Systems Limited.

**STOKES**  
STOKES SYSTEMS LTD

Detail Ref.

**08T-STD/14**

Date. May 2005	Rev. D
System. 08	Scale. 1=2